

**ENVIRONMENTAL PROTECTION ACT 1990
PART 2 (WASTE ON LAND)**

Waste Management Licence Number:

~~170/90~~

80448

Holder of Licence:

E.D.Edwards Waste Management
'Barnfield', Tylers Cross
Roydon, Essex CM19 5DP

Location of Facility:

'Barnfield'
Tylers Cross, Roydon

Nature of Facility:

Transfer

Trading Standards Department
Beehive Lane
Chelmsford, CM2 9BY
TEL: 045 355381



Essex County Council
Trading Standards

ENVIRONMENTAL PROTECTION ACT, 1990.

Notice of Modification of Waste Disposal Licence Conditions.

THE ESSEX COUNTY COUNCIL
in pursuance of its powers under Section 37 of the
ENVIRONMENTAL PROTECTION ACT, 1990
hereby modifies Waste Disposal Licence No. 170/90
held by: E.D. Edwards Waste Management Limited
Waste Transfer Station
'Barnfield'
Tylers Cross
Roydon CM19 5DZ

in respect of lands (hereinafter called 'the site')
at: 'Barnfield'
Tylers Cross
Roydon
Essex

in the District of Epping Forest

by deleting licence Condition 15 and inserting the following condition with
immediate effect:-

15. Records shall be kept of all waste deposited. For each vehicle
entering the site such records shall include:-
- (a) the registered numbers assigned under S.19 of the
Vehicles (Excise) Act, 1971;
 - (b) the type of waste carried;
 - (c) the weight, in tonnes, of the load (in the event of a
weighbridge not being available, the volume of waste
shall be recorded as the carrying capacity of the
vehicle in cubic metres); and
 - (d) the origin of the waste.

The licence holder shall use his best endeavours to obtain
information on the origin of the waste. This is to be recorded as
the Borough or District Council area.

All such records shall be kept at the site office and be made
available to any duly authorised officer as and when required.

A monthly summary in the form specified in Annex Y of such records
shall be sent by the holder to the County Council not later than
the 21st of the following month.

Dated this 22nd day of June 1994.

[Signature]
County Trading Standards Officer.

Essex County Council,
Trading Standards Department,
Beehive Lane,
Chelmsford,
Essex CM2 9SY
Telephone: Chelmsford 355381

CONTROL OF POLLUTION ACT, 1974.

Notice of Modification of Waste Disposal Licence Conditions.

THE ESSEX COUNTY COUNCIL

In pursuance of its powers under Section 7 of the

CONTROL OF POLLUTION ACT, 1974

hereby modifies Waste Disposal Licence No. 170/90

held by: E.D. Edwards Waste Management Limited,
Waste Transfer Station,
"Barnfield",
Tylers Cross,
Roydon,
Essex CM19 5DP

in respect of lands (hereinafter called 'the site')

at "Barnfield",
Tylers Cross,
Roydon.

in the District of Epping Forest

by deleting the current Condition 24 and inserting the following
Conditions with immediate effect:-

Condition 29. The amounts of waste stored and transferred each year
shall be less than 25000 tonnes.

Condition 30. For the purposes of the condition relating to annual
volume limitations the year shall commence on 1st April
and end on 31st March the following year.

Dated this 29th day of April, 1994.

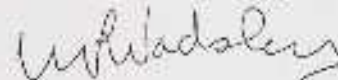

County Trading Standards Officer.

Essex County Council,
Trading Standards Department,
Beehive Lane,
Chelmsford,
Essex CM2 9SY

Telephone: Chelmsford 355381

THE ESSEX COUNTY COUNCIL

hereinafter called "THE COUNTY COUNCIL"

in pursuance of its powers under Section 5 of the

CONTROL OF POLLUTION ACT 1974

and subject to the terms and conditions contained

in the schedule hereto

HEREBY ISSUE A DISPOSAL LICENCE

to

E.D. Edwards Waste Management Limited,

Waste Transfer Station,

"Barnfield",

Tylers Cross,

Roydon,

Essex CM19 5DP

to transfer

CONTROLLED WASTE

on lands (hereinafter called 'the site')

at "Barnfield",

Tylers Cross,

Roydon,

Essex.

in the DISTRICT OF EPPING FOREST

as delineated on the plan attached hereto and

thereon edged in red.

Control of Pollution Act, 1974.

Waste Disposal Licence for Transfer Station, Barnfield, Roydon.

Schedule of Terms and Conditions.

"Hazardous waste" includes any poisonous, noxious or polluting substance (whether solid, semi-solid or liquid) presence of which on land is liable to give rise to an environmental hazard and the expression 'non-hazardous' shall be construed accordingly.

"Clinical waste" means waste arising from a hospital, clinic, blood transfusion centre or laboratory of a kind categorised by paragraph 4 of the Health and Safety Committee report dated 1982 and entitled "The Safe Disposal of Clinical Waste".

1. Materials to be deposited.

Waste handled at the site shall be limited to the following types or categories:-

Household, commercial and solid, non-hazardous industrial wastes.

2. Site Preparation and Works.

A permanent roadway shall be provided within the site. The road shall run from the site entrance to the operational area and shall be maintained to the satisfaction of the County Council.

3. The operational area of the site shall be properly surfaced and maintained in good order at all times.

4. A site control office shall be provided on or near the site.

5. A site identification board of durable materials shall be erected in a prominent position at the site entrance. This board shall display the following information:-

(a) the name of the site;

(b) the name, address and telephone number of the operator and his local agent;

(c) the hours when the site is open; and

(d) the address and telephone number of the County Council.

6. Gates and fencing shall be provided and maintained to the reasonable satisfaction of the County Council and all reasonable precautions shall be taken to prevent unauthorised access to the site.

7. Suitable and sufficient lighting shall be provided to facilitate the use of the site during the hours of darkness.
8. No discharge of surface or waste water shall be made to any watercourse or sewer without the prior consent of the National Rivers Authority.
9. The site shall be adequately manned and supervised during working hours.
10. All waste delivered to the site shall only be deposited within the operational area. Waste shall be removed from the operational area and placed in containers throughout the working day such that by the end of the working day all waste shall have been placed in containers.
11. No waste material shall be burnt within the site and a fire at the site shall be regarded as an emergency and immediate action shall be taken to extinguish it. All outbreaks of fire shall forthwith be notified to the County Consumer and Public Protection Officer.
12. Precautions shall be taken to prevent the breeding and harbouring of insects and vermin on the site and immediate steps shall be taken to secure the destruction of any discovered.
13. The site road shall, in dry weather, be sprayed with water to suppress dust.
14. All reasonable precautions in addition to those specifically mentioned shall be taken to prevent nuisance arising on or from the site as a result of the use thereof for the reception of waste and to ensure that the site is kept in a tidy condition.
15. A record shall be kept of the types and quantities of waste handled.
16. The terms of the site licence shall be made known to any person who is given responsibility for the management or control of the site and a copy of the licence shall be displayed at the site control office.
17. Not less than 14 days notice shall be given to the County Council of the date on which operations are to commence or re-commence in the event of a temporary cessation for a period in excess of three months.
18. Any temporary cessation of operations for a period in excess of three months shall be notified to the County Council.
19. Operations at the site shall not take place on Sundays and Bank Holidays or outside the hours of 7.30a.m to 6p.m Monday to Friday and 8a.m to 1p.m Saturday

CONTROL OF POLLUTION ACT, 1974.

Notice of Modification of Waste Disposal Licence Conditions.

THE ESSEX COUNTY COUNCIL

in pursuance of its powers under Section 7 of the

CONTROL OF POLLUTION ACT, 1974

hereby modifies Waste Disposal Licence No. 170/90

held by: E.D. Edwards Waste Management Limited,
Waste Transfer Station,
"Barnfield",
Tylers Cross,
Roydon,
Essex CM19 5DP

in respect of lands (hereinafter called 'the site')

at "Barnfield",
Tylers Cross,
Roydon,
Essex SS17 0EH

in the District of Epping Forest

by deleting the existing Condition 24 and inserting the following condition with immediate effect:-

Condition 24. ~~This licence shall expire on 15th September, 1995.~~ ~~See Condition~~
(30)

Dated this 17th day of September, 1992.

M. A. Wadley

County Trading Standards Officer.

Essex County Council,
Trading Standards Department,
Beehive Lane,
Chelmsford,
Essex CM2 9SY

Telephone: Chelmsford 355381

20. A record shall be maintained to the satisfaction of the County Council of all incidents which occur on the site whereby there is a material risk to the health or safety of any person.
21. All notices and notifications required by the terms and conditions of this licence shall be forwarded to the County Consumer and Public Protection Officer, Beehive Lane, Chelmsford CM2 9SY.
22. No clinical waste as defined in this licence shall be deposited on the site.
23. All vehicles delivering waste to the site shall be properly covered or sheeted to ensure that no spillage occurs.
24. ~~This licence shall expire on 19th September, 1995.~~
25. The site shall be equipped with a loading shovel or other suitable mechanical device to facilitate transfer of the waste from the operational area into containers.
26. The maximum number of full containers on site at any one time shall be three.
27. Before containers are removed from the site they shall be properly sheeted or covered to ensure that no spillage occurs.
28. Containers shall be removed from the site and deposited at another suitably licensed site within two working days of any waste being placed therein.

Dated this ⁴ day of January, 1990.

J. B. Thompson
County Consumer and Public Protection Officer.

Essex County Council,
Consumer and Public Protection Department,
Beehive Lane,
Chelmsford CM2 9SY

Telephone: Chelmsford 355381

20. A record shall be maintained to the satisfaction of the County Council of all incidents which occur on the site whereby there is a material risk to the health or safety of any person.
21. All notices and notifications required by the terms and conditions of this licence shall be forwarded to the County Consumer and Public Protection Officer, Beehive Lane, Chelmsford CM2 9SY.
22. No clinical waste as defined in this licence shall be deposited on the site.
23. All vehicles delivering waste to the site shall be properly covered or sheeted to ensure that no spillage occurs.
24. ~~This licence shall expire on 19th September, 1995.~~
25. The site shall be equipped with a loading shovel or other suitable mechanical device to facilitate transfer of the waste from the operational area into containers.
26. The maximum number of full containers on site at any one time shall be three.
27. Before containers are removed from the site they shall be properly sheeted or covered to ensure that no spillage occurs.
28. Containers shall be removed from the site and deposited at another suitably licensed site within two working days of any waste being placed therein.

Dated this 4th day of January, 1990.

J. B. Hewson
County Consumer and Public Protection Officer.

Essex County Council,
Consumer and Public Protection Department,
Beehive Lane,
Chelmsford CM2 9SY

Telephone: Chelmsford 355381

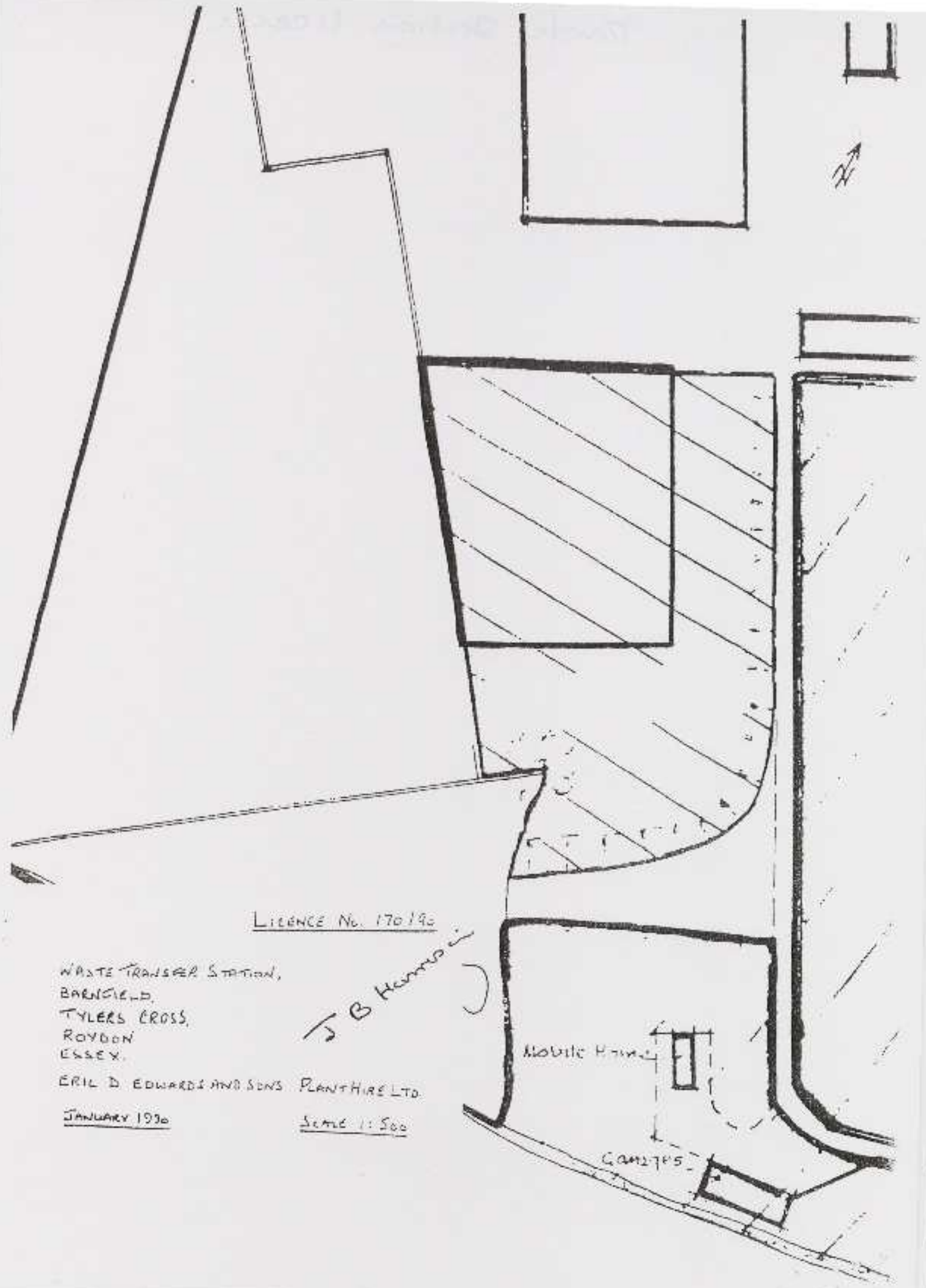

LICENCE No. 170190

WASTE TRANSFER STATION,
BARFIELD,
TYLERS CROSS,
ROYDON
ESSEX.

ERIL D EDWARDS AND SONS PLANTHIRE LTD

JANUARY 1930

B. HARRISON

SCALE 1:500

Mobile Home

CAMP